

Circular UNEF Connector Interfaces

Circular connector interface dimensions

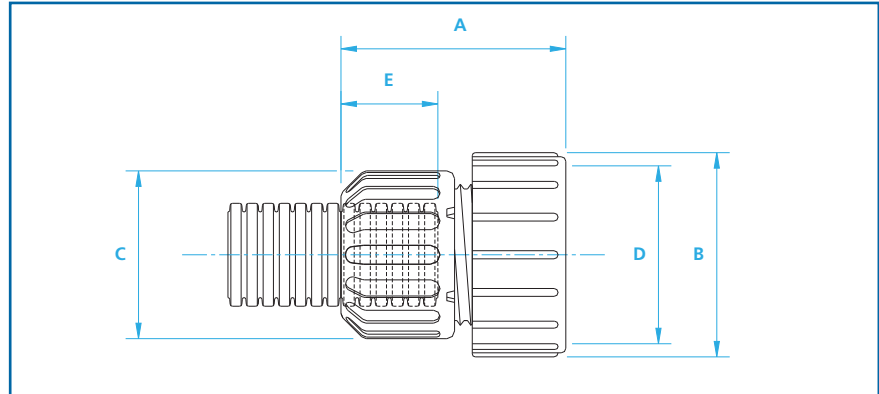

Description

Straight compression type fittings providing connection between military style circular connections and conduit systems.

These fittings are designed for use with all types of unslit conduit thus maintaining maximum conduit bore.

Configurations/part numbers

Part No.	Interface Body	Cap Nut	Sealing Bush	Face Sealing Washer	Conduit Sizes (NC)	Conduit Sizes (NW)	Thread Size
TMPA01	TCN07	TCN07	TSRN07	TSWPG07	10	8.5	5/8"-24 UNEF
TMPA01	TCN09	TCN09	TSRN09	TSWPG07	12	10	5/8"-24 UNEF
TMPA03	TCN16	TCN16	TSRN16	TSWM20	20	17	1"-20 UNEF
TMPA04	TCN16	TCN16	TSRN16	TSWPG16	20	17	1 3/16"-18 UNEF
TMPA05	TCN21	TCN21	TSRN21	TSWM25	25	22	1 7/16"-18 UNEF
TMPA05	TCN28	TCN28	TSRN28	TSWM25	28	23	1 7/16"-18 UNEF
TMPA08	TCN07	TCN07	TSRN07	TSWPG09	10	8.5	3/4"-20 UNEF
TMPA08	TCN09	TCN09	TSRN09	TSWPG09	12	10	3/4"-20 UNEF

*NOTE: order interface bodies, cap nuts, sealing bushes and sealing washers separately

Accessories

For extending the capability of sealed fittings, consult us for the following: clamping rings, end sleeves/end caps, grommet seals, locknuts, face sealing washers, thread reducers/enlargers.

Order interface bodies, cap nuts and sealing bushes separately.

Nominal dimensions

Part No.	Interface Body	A	B	C	Thread Size	D	E
TMPA01	TCN07	30	24	23	5/8"-24 UNEF	17	
TMPA03	TCN16	33	36	31	1"-20 UNEF	20	
TMPA04	TCN16	32	37	31	1 3/16"-18 UNEF	20	
TMPA05	TCN21	37	44	39	1 7/16"-18 UNEF	21	
TMPA08	TCN07	30	32	23	3/4"-20 UNEF	17	

*NOTE: dimensions are in mm and refer to overall assembly