

## Metallic Glands

A cable gland (cable fitting) is a cable entry system that attaches to and secures a cable to electrical equipment allowing the cable or wire to enter an enclosure while sealing out dust, dirt and liquids and providing strain relief.

Metal cable glands provide protected cable entry into enclosures or electrical equipment, securing cables or wires while maintaining enclosure sealing requirements.

## A2 Glands

General purpose A2 brass stuffing glands are suitable for use with all types of unarmoured cables, providing mechanical cable retention and an IP66/IP67/IP68 environmental displacement seal onto the cable's outer sheath. The A2 gland is suitable for both indoor and outdoor installations.

Suitable for use with all types of unarmoured cables.

| Part Number | Material            | Gland Size No | Mounting Hole [mm] |
|-------------|---------------------|---------------|--------------------|
| T/PX00A2-16 | Nickel Plated Brass | 00            | 16mm               |
| T/PX00A2    | Nickel Plated Brass | 01            | 20mm               |
| T/PX0A2     | Nickel Plated Brass | 0             | 20mm               |
| T/PX1A2     | Nickel Plated Brass | 1             | 20mm               |
| T/PX2A2     | Nickel Plated Brass | 2             | 25mm               |
| T/PX3A2     | Nickel Plated Brass | 3             | 32mm               |
| T/PX4A2     | Nickel Plated Brass | 4             | 40mm               |
| T/PX5A2     | Nickel Plated Brass | 5             | 50mm               |
| T/PX6A2     | Nickel Plated Brass | 6             | 63mm               |
| T/PX7A2     | Nickel Plated Brass | 7             | 75mm               |

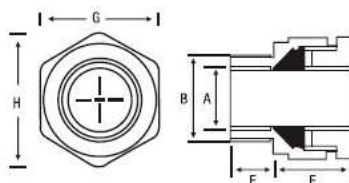

# Trans Technical Solutions

Tel: +27 11 974 9679  
Fax: +27 11 974 9653  
Email: sales@ttsafrica.com

P O Box 5094  
Delmenville  
1403

Unit F11, Roete 24  
Meadowdale  
Germiston



## Metallic Glands

### BWR Glands

**BWR Brass Cable glands** provides the best performance and have a longer service life span for various applications. It is made, keeping in mind all the satisfying quality standard and industrial guidelines.

Provide mechanical cable retention & electrical continuity via armoured wire termination and protect armour wire.

- Can be used in outdoor and indoor application.
- Provide clamping of the armoured cables.
- Ensures earth continuity.
- Used with all types of SWA cable for providing seals on cable inner and outer sheath.

| Part Number | Material            | Gland Size No | Mounting Hole [mm] |
|-------------|---------------------|---------------|--------------------|
| T/PX0BW     | Nickel Plated Brass | 0             | 20mm               |
| T/PX1BW     | Nickel Plated Brass | 1             | 20mm               |
| T/PX2BW     | Nickel Plated Brass | 2             | 25mm               |
| T/PX3BW     | Nickel Plated Brass | 3             | 32mm               |
| T/PX4BW     | Nickel Plated Brass | 4             | 40mm               |
| T/PX5BW     | Nickel Plated Brass | 5             | 50mm               |
| T/PX6BW     | Nickel Plated Brass | 6             | 63mm               |
| T/PX7BW     | Nickel Plated Brass | 7             | 75mm               |

